

M8274

SERIAL NO. UP TO 337844

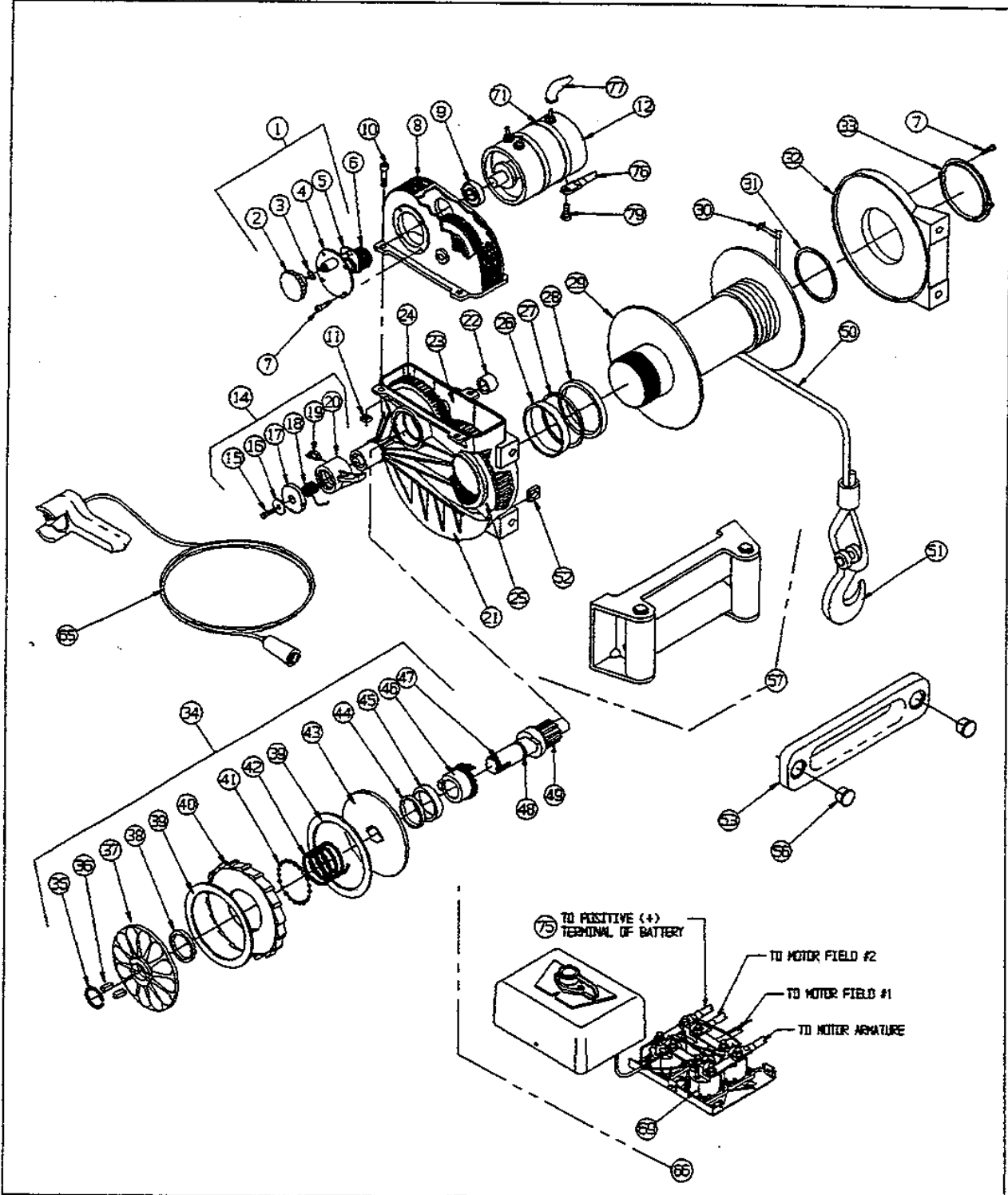

WARN M8274 WINCH REPLACEMENT PARTS LIST			
SERIAL NO. UP TO 337844			
ORDERING INFORMATION: When ordering please give Warn Model, Serial Number & Battery voltage. Part may be obtained through your local dealer or distributor.			
ITEM	QTY	PART NO	DESCRIPTION
1	1	8326	CLUTCH ASSEMBLY, (Includes item 2 thru 5)
2	1	8328	SHIFT KNOB
3	1	7596	SEAL
4	1	8325	CLUTCH HOUSING
5	1	8322	SHIFTER ASSEMBLY
6	1	15879	Motor Pinion Gear-Splined
		9054	Motor Pinion Gear-Keyed
7	4	8548	SCREW, 10-24 x 3/8"
8	1	9285	UPPER HOUSING ASSY, (Includes item 9 and cluster gears)
NOTE: Due to technical assembly requirements, the upper housing and cluster gears are not sold separately.			
9	1	8316	ARMATURE, BEARING
10	3	3962	CAPSCREW, 5/16-18 x 3/4"
11	3	7953	SQUARE NUT, 5/16-18
12	1	7536	MOTOR, 12 VDC
	1	8803	MOTOR, 24 VDC
14	1	7605	PAWL ASSEMBLY, (Includes item 15 thru 20)
15	1	8867	CAPSCREW, 1/4-20 x 1/2"
16	1	9256	WASHER
17	1	9220	PROTECTIVE CAP
18	1	9257	PAWL SPRING
19	1	9245	GREASE FITTING
20	1	+	PAWL
21	1	7594	LOWER HOUSING ASSY, (Includes item 22, 26 and 27)
22	1	8356	BEARING
23	1	7552	RETAINING PLATE
24	1	7548	INTERMEDIATE GEAR
25	1	7550	MAIN GEAR
26	1	#	BUSHING (IN 8680 KIT)
27	1	#	SEAL (IN 8680 KIT)
28	1	#	THRUST WASHER (IN 8680 KIT)
29	1	7780	DRUM
30	1	2048	WIRE ROPE CLAMP
31	1	#	BUSHING (IN 8680 KIT)
32	1	7532	END SUPPORT ASSEMBLY, (Includes item 31, 33 and 7)
33	1	7582	END CAP
	1	8680	SERVICE KIT, LOWER HOUSING (Includes item 26 thru 28 and 31)
34	1	7634	BRAKE ASSEMBLY, (Includes item 35 thru 49)
35	1	7614	RETAINING RING
36	2	7668	KEY

WARN M8274 WINCH REPLACEMENT PARTS LIST			
SERIAL NO. UP TO 337844			
ORDERING INFORMATION: When ordering please give Warn Model, Serial Number & Battery voltage. Part may be obtained through your local dealer or distributor.			
ITEM	QTY	PART NO	DESCRIPTION
37	1	8703	OUTER BRAKE DISC
38	1	^	HUB (IN 8409 KIT)
39	2	9734	FRICTION MATERIAL
40	1	7601	RATCHET
41	21	^	STEEL BALL (IN 8409 KIT)
42	1	^	SPRING (IN 8409 KIT)
43	1	7600	INNER BRAKE DISC
44	1	7612	LIP SEAL
45	1	7611	BUSHING
46	1	7562	SPLINED CAM
47	1	7732	PINION AND CAM (Includes item 49)
48	1	7613	O-RING SEAL
49	1	(See Item 47) 8409	CAM PART OF 7732 BRAKE SERVICE KIT, (Includes item 35, 36, 38 39, 41, 42, 44, 45, and 48)
NOTE: Winches serial numbered 46945 and lower must replace part number 7601 ratchet when using the kit			
50	1	2601	WIRE ROPE ASSEMBLY
51	1	5320	HOOK, 3/8"
52	2	7616	SQUARE NUT
53	1	7608	FAIRLEAD, HAWSE
54	2	2146	LOCKWASHER, 7/16
55	4	7165	CAPSCREW, 7/16-14x1-1/2
56	2	2107	SOFT PLUG
57	1	5742	ROLLER FAIRLEAD
65	1	38626	REMOTE CONTROL
66	1	38844	SOLENOID PACK, 12 V
66	1	38846	SOLENOID PACK, 24V
NOTE: The following parts are common with all serial numbers.			
69	4	28396	SOLENOID, UPRIGHT TERMINAL
71	2	6005	CLAMP
75	1	33295	CABLE, ELECTRIC, 7Z (RED)
76	1	15901	CABLE, GROUND, 7Z (BLACK)
77	3	2090	BOOT, ELECTRICAL TERMINAL
79	1	34402	CAPSCREW, HEX HEAD, M8 X 2.25 X 20mm

+ INCLUDED IN 7605 ASSEMBLY
INCLUDED IN 8680 KIT
^ INCLUDED IN 8409 KIT